

REVISIONS				
NO.	REV.	DESCRIPTION	DATE	APPROVED
1	A	INITIAL RELEASE		K. NOBLE

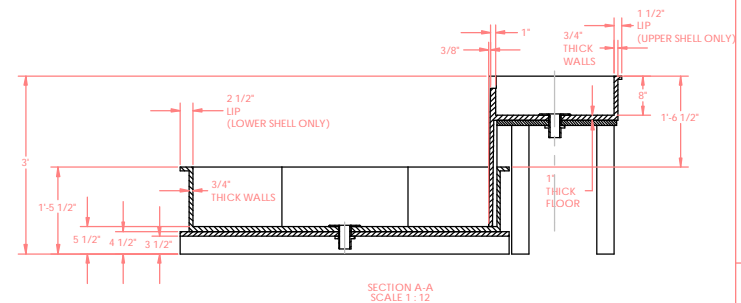
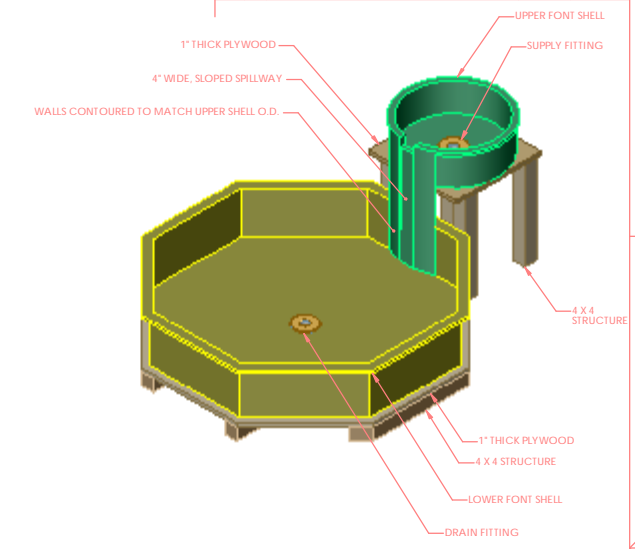

* UNLESS OTHERWISE SPECIFIED DIMENSIONS ARE IN INCHES TOLERANCES ON LEVEL PLUMBS ± 1/16" ± 1/16"	DRAWING NUMBER D193	Water Structures 40 Strand St. Sudbury, MA 01546 (603) 474-0600
	PROJECT ST. MADELINE BAPTISTICAL FONT SHELL CONSTRUCTION	
DRAWN BY Rick Frederickson	DATE 01/14/03	SHEET NO. D193
CHECKED BY Kim Noble	DATE 01/14/03	SCALE 1"=1'
DESIGNED BY Kim Noble	DATE 01/14/03	SHEET NO. A